



ZT5201E-L

The new, larger ZT5200E-L 3-bladed mower has a fabricated deck and larger wheels to support any additional weight, as well as a range of comfort features. The lap bars make for an intuitive operation while the 3 driving modes and 4 blade speeds allow you to fully customise your ride.

Product Details

Model Name	132cm Z6 ZERO TURN RIDING MOWER
------------	---------------------------------

Marketing Information

Model Name	132cm Z6 ZERO TURN RIDING MOWER
------------	---------------------------------

Category Bullets	The new, larger ZT5200E-L 3-bladed mower has a fabricated deck and larger wheels to support any additional weight, as well as a range of comfort features.
------------------	--

PDP Short Description	The new, larger ZT5200E-L 3-bladed mower has a fabricated deck and larger wheels to support any additional weight, as well as a range of comfort features. The lap bars make for an intuitive operation while the 3 driving modes and 4 blade speeds allow you to fully customise your ride.
-----------------------	--

Long Description	The new, larger ZT5200E-L 3-bladed mower has a fabricated deck and larger wheels to support any additional weight, as well as a range of comfort features. The lap bars make for an intuitive operation while the 3 driving modes and 4 blade speeds allow you to fully customise your ride.
------------------	--

Packaging Contains	1x 132cm Z6 Zero Turn Riding Mower [ZT5200E-L] 1x 1600W Charger [CHV1600E]
--------------------	---

Technical Specifications

EAN/UPC Local	4894863100641
---------------	---------------

ITF Code(Master Carton)	xxxxxx
-------------------------	--------

Model Number (Item)	{Order No. CSO}
---------------------	-----------------

Order No.	ZT5201E-L
-----------	-----------

Battery Port	Multi Port
--------------	------------

Brushless Motor	Brushless
Control	Lap Bar ZTR
Cutting Options	Side discharge, Bagging, Mulching
Number Of Blade	3
Deck Construction	Fabricated
Cut Height Number	10
Light	Yes
Seat Suspension	Yes
LCD Display	5 in
IP Class	IPX4
Cutting Width (cm)	132
Cutting Width (inch)	52
USB Charging Port	Yes
LED Headlights	Yes
Floor Mat	Yes
Status Indicator	Yes
Cup Holder	Yes
Glove Box	Yes
Phone Holder	Yes
Tow Hitch	Yes
Beeper	Yes
Parking Break	Yes
Autohold	Yes
Slope Assit	Yes
Connectivity	Yes
Grass Bagger	Yes
Mulching Plug	Yes

KEES VAN DER SPEK
TUINMACHINES ★ STOLWIJK

Forward Speed (MPH)	8
Reverse Speed (MPH)	4
Cut Height (inch)	4.5
Seat (inch)	18
Tool Weight (lbs)	485

Marketing Features

Autohold	Yes
Beeper	Yes
Connectivity	Yes
Cup Holder	Yes
Floor Mat	Yes
Glove Box	Yes
Grass Bagger	Yes
Light	Yes
Mulching Plug	Yes
Parking Break	Yes
Phone Holder	Yes
Slope Assit	Yes
Status Indicator	Yes
Tow Hitch	Yes
USB Charging Port	Yes
LED Headlights	Yes

Packaging Details

Packaging Type	Item	Single Pack	Master Pack Outer Carton (Kraft)
Packaging Measurement Unit Type	Metric	Metric	Metric
Quantity	1	1	1
Weight		209.60	213.65
Weight Unit		Kilogram	Kilogram

Height (H)	83	83
Height Unit	Centimetre	Centimetre
Width (L)	213	213
Width Unit	Centimetre	Centimetre
Depth (W)	148	148
Depth Unit	Centimetre	Centimetre
Gross Weight Incl Packaging	213.70	301.75
Gross Weight Incl Packaging Unit	Kilogram	Kilogram
Commodity Code / Tariff Code	8433111000	
Item Number		

Accessories

EGO AB5200 BAGGING BLADE FOR ZT5200E-L



EGO AB5201 46cm BAGGING BLADE



EGO ABP5200 MULCHING KIT FOR ZT5200E-L



KEES VAN DER SPEK
TUINMACHINES * STOLWIJK

EGO ABK5200-A BAGGING KIT FOR ZT5200E-L



EGO ACA1000 CHARGING ADAPTOR



EGO CRM001 RIDE-ON MOWER COVER



EGO AMG1000 ZERO TURN RIDING MOWER ON-BOARD STORAGE



EGO AMS1000 ZERO TURN RIDING MOWER SUN SHADE



EGO AMB1000 ZERO TURN RIDING MOWER REAR BUMPER BAR



Main



ZT5201E-L_EGOEU_RIDE-ON-MOWER_MAIN_01.psd

Date created: 2023-10-19T07:12:27:000+0000

Date Changed: 2023-10-18T03:07:00:000+0000

Manual



OP_EGO_ZT5200E-L_EV03.31_221014.pdf

Date created: 2022-12-30T07:50:58:000+0000

Date Changed: 2022-10-15T03:31:13:000+0000



MNL_EGO_CHV1600E_EV01.31_220624.pdf

KEES VAN DER SPEK
TUINMACHINES * STOLWIJK

Explosion Diagrams

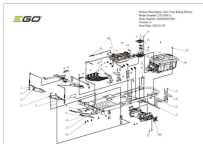

Explosion diagram_ZT5200E-L_A_23-0106.pdf

Date created: 2023-01-10T08:03:16:000+0000

Date Changed: 2023-01-06T08:40:54:000+0000

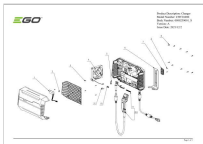

Explosion diagram_CHV1600E_A_22-0119.pdf

Date created: 2022-01-19T07:25:02:000+0000

Date Changed: 2022-01-19T07:25:02:000+0000

Compliance Reports



CE_EGO_ZT5200E-L_EV03.31_231222.pdf

Date created: 2024-02-02T02:44:04:000+0000

Date Changed: 2024-02-01T08:00:12:000+0000

KEES VAN DER SPEK
TUINMACHINES ★ STOLWIJK