



IPL, Turbo Lite 400, 9634100-62, 2005-11

Turbo Lite 400



Factory:

Product Group:

Sub Group:

Publication Date:

Publication Number:

FLM - Newton Aycliffe

OM 78

Electric Hover: 7890

15/11/05

AP0511007

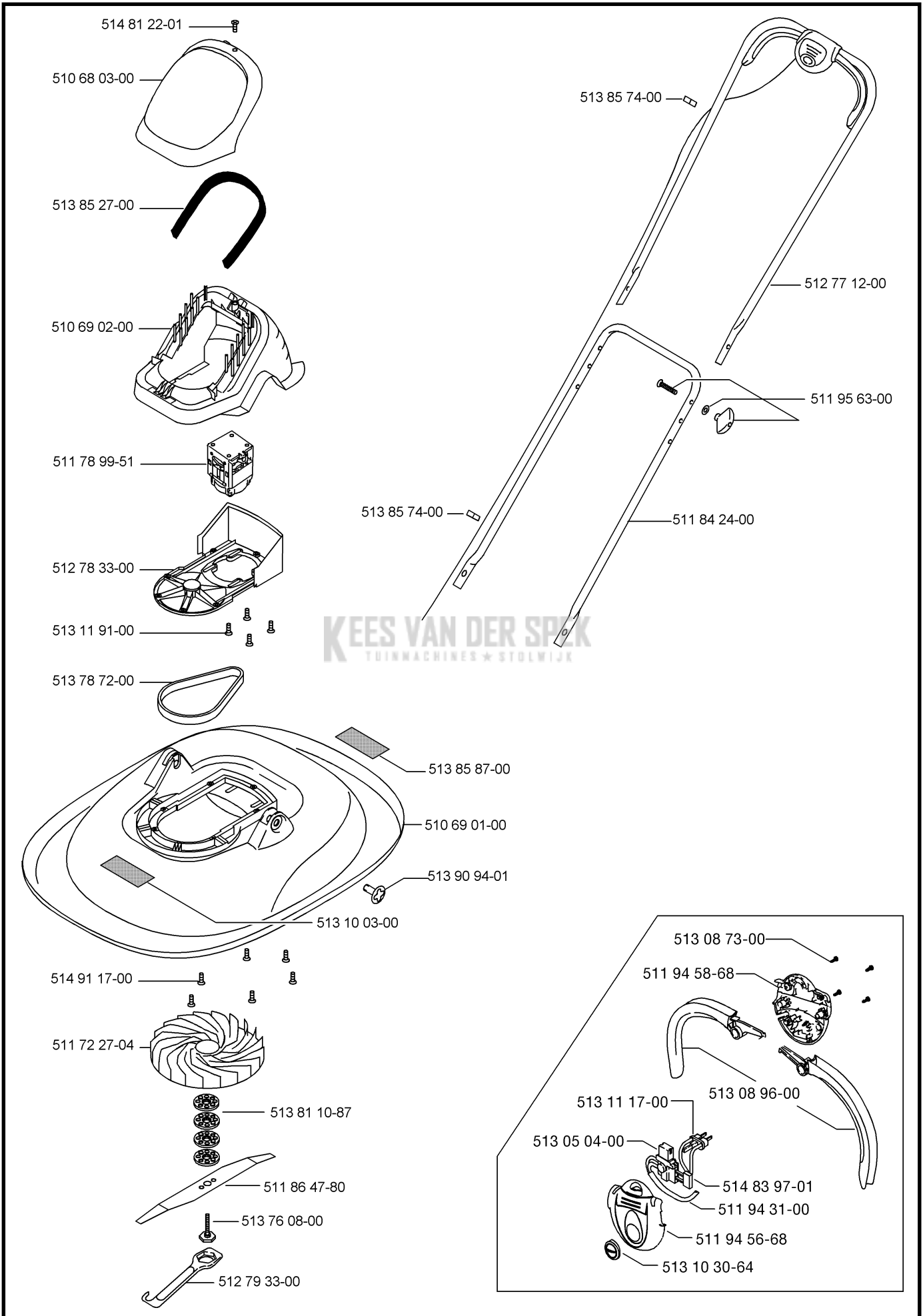

| Part Number | Description | Qty | Note |
|--------------|--------------------------------|-----|------|
| 510 68 03-00 | COWL UPPER | 1 | |
| 510 69 01-00 | HOOD 40cm | 1 | |
| 510 69 02-00 | COWL LOWER | 1 | |
| 511 72 27-04 | IMPELLER | 1 | |
| 511 78 99-51 | MOTOR AMETEK | 1 | |
| 511 84 24-00 | HANDLE LOWER E330 | 1 | |
| 511 86 47-80 | BLADE 40CM TL400 | 1 | |
| 511 94 31-00 | LEAD ASSY | 1 | |
| 511 94 56-68 | SWITCHBOX UPPER | 1 | |
| 511 94 58-68 | SWITCHBOX LOWER EURO | 1 | |
| 512 77 12-00 | HANDLE UPPER COATED | 1 | |
| 512 78 33-00 | MOTOR DRIVE ASSY TL | 1 | |
| 512 79 33-00 | ABS SPANNER (PLASTIC) | 1 | |
| 512 81 55-64 | WING KNOB (CUSTOMER ASSY) | 2 | |
| 513 05 04-00 | SWITCH 8A | 1 | |
| 513 08 73-00 | SCREW | 4 | |
| 513 08 96-00 | LEVER KIT | 1 | |
| 513 10 03-00 | LABEL TURBO 400 | 1 | |
| 513 10 30-64 | BUTTON LOCK OFF | 1 | |
| 513 11 17-00 | PIN RETAINER | 1 | |
| 513 11 91-00 | Screw-Cap Washer 6 Spline | 4 | |
| 513 76 08-00 | BLADE BOLT ASSY (BROWN) | 1 | |
| 513 78 72-00 | DRIVE BELT - 406 J5 | 1 | |
| 513 81 10-87 | BLADE SPACER | 2 | |
| 513 85 27-00 | FILTER FOAM | 1 | |
| 513 85 74-00 | CABLE CLIP | 2 | |
| 513 85 87-00 | LABEL:WARNING (ELECTRIC) | 1 | |
| 513 90 94-01 | PIN PIVOT | 2 | |
| 514 81 22-01 | SCREW PLASTITE NO.10 x 19MM LG | 1 | |
| 514 91 17-00 | SCREW | 7 | |

KEES VAN DER SPEK
TUINMACHINES ★ STOLWIJK